

Drill Sequence for TSIII Ultra-Wide Fixture - Ultra KIT (HULTRK)

ø 6.0 mm Fixture (Length : 10mm)

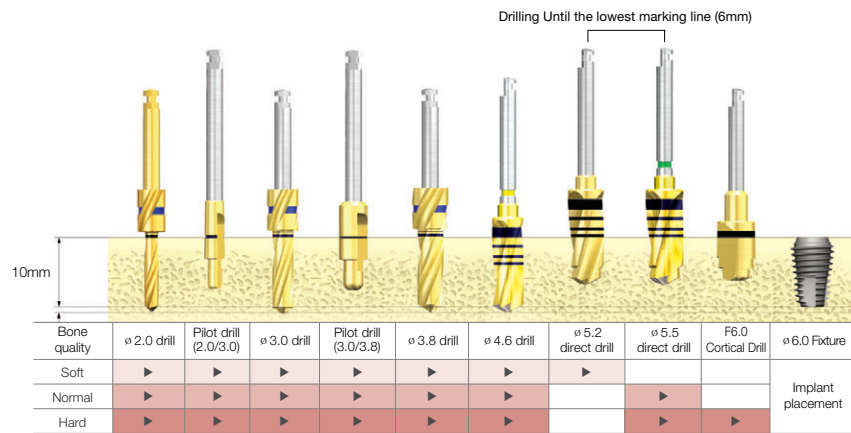

ø 7.0 mm Fixture (Length : 10mm)

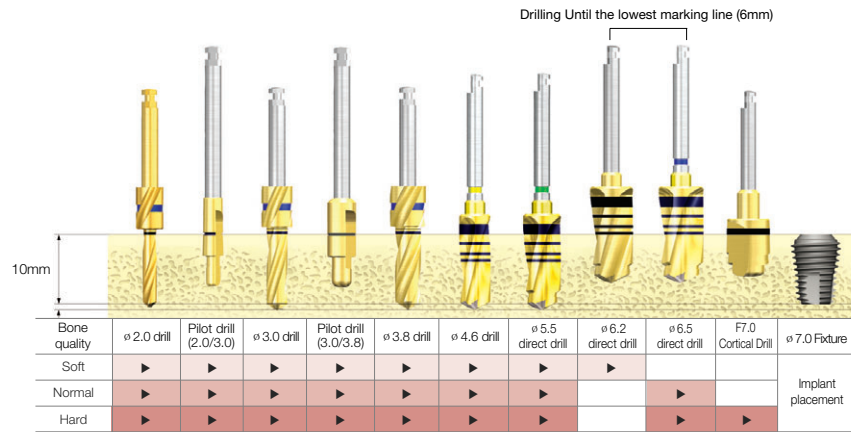

Drill Sequence for TSIII Ultra-Wide Fixture - Taper Ultra KIT (HULTPK)

ø 6.0 mm Fixture (Length : 10mm)

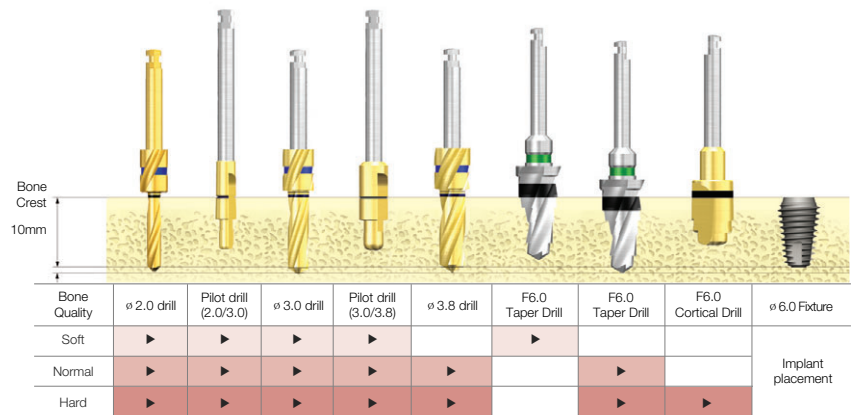

ø 7.0 mm Fixture (Length : 10mm)

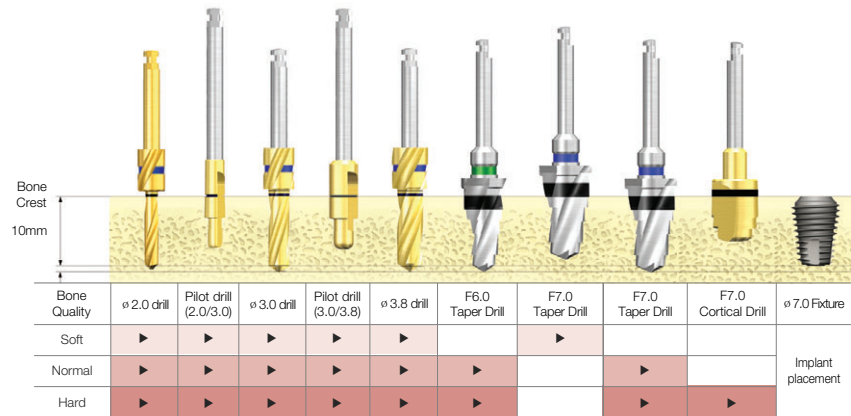

※ TS / GS fixture implant depth guide

- In case of normal or higher-quality bone, it is recommended to implant deeper than bone level by 1mm or less.
- In case of soft bone, it is recommended to implant to meet the bone level for maintenance of anchoring force.

OSSTEM
IMPLANT

HEAD OFFICE

8th FL, WorldMeridian Venture Center II, 426-5, Gasan-dong, Geumcheon-gu, Seoul, Korea
Tel : 02-2016-7000 Fax : 02-2016-7001 www.osstem.com

Edition 02 / 2012

TSIII Ultra-Wide Implant

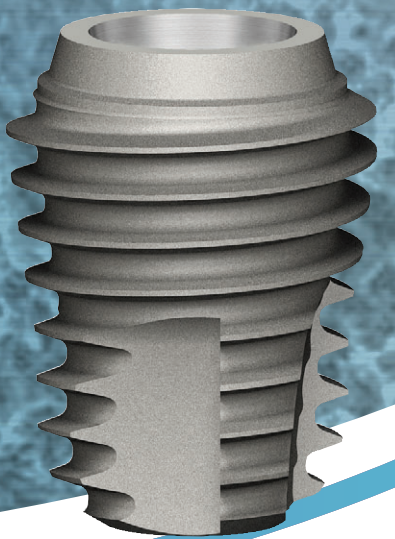

Indication of TSIII Ultra-Wide Fixture

- Immediate placement at the extraction socket
- Immediate replacement of the failed implant

OSSTEM
IMPLANT

TSIII Ultra-Wide Implant

TSIII Ultra-Wide Implant

TSIII Ultra-Wide Implant Package

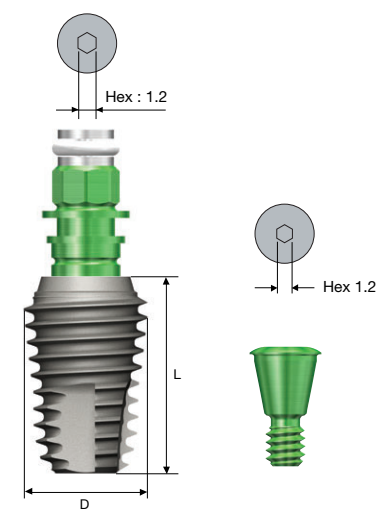

TSIII Ultra - Wide® Fixture Order Code

Fixture Only
- Fixture : Product Code [ex : TS3S6010S]

Pre-Mounted Fixture [Simple Mount]
- Fixture + Simple Mount + Cover Screw : B + Fixture Product Code [ex : BTS3S6010S]

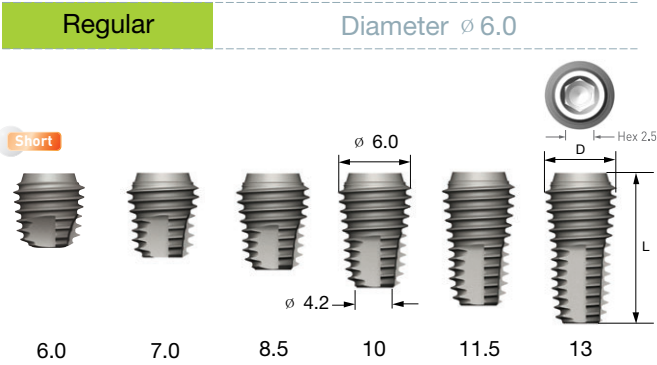

Connection		Regular
L	D	\varnothing 6.0
6		TS3S6006S
7		TS3S6007S
8.5		TS3S6008S
10		TS3S6010S
11.5		TS3S6011S
13		TS3S6013S

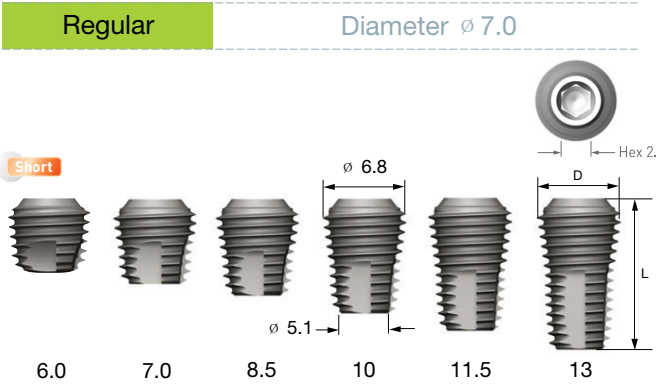

Connection		Regular
L	D	\varnothing 7.0
6		TS3S7006S
7		TS3S7007S
8.5		TS3S7008S
10		TS3S7010S
11.5		TS3S7011S
13		TS3S7013S

Features of TSIII Ultra-Wide

- SA (Sand blasted with alumina and Acid etched) Surface Treatment (Ra 2.5~3.0 μ m)
- Submerged wide diameter fixture with Internal hex connection
- Compatible with GS Regular abutment components
- Useful for immediate placement for posterior and replacing failed implants
- Optimal apex design allows the implants to achieve ideal initial stability
- Rigid motion with superstructure helps maintain stable connection
- Recommended Torque : below 40Ncm
- The actual length of TSIII Ultra-Wide Fixture is 0.5mm shorter than actual length. (Exception 7mm)

Surgical Kit for TSIII Ultra-Wide Fixture

Ultra KIT (HULTRK)

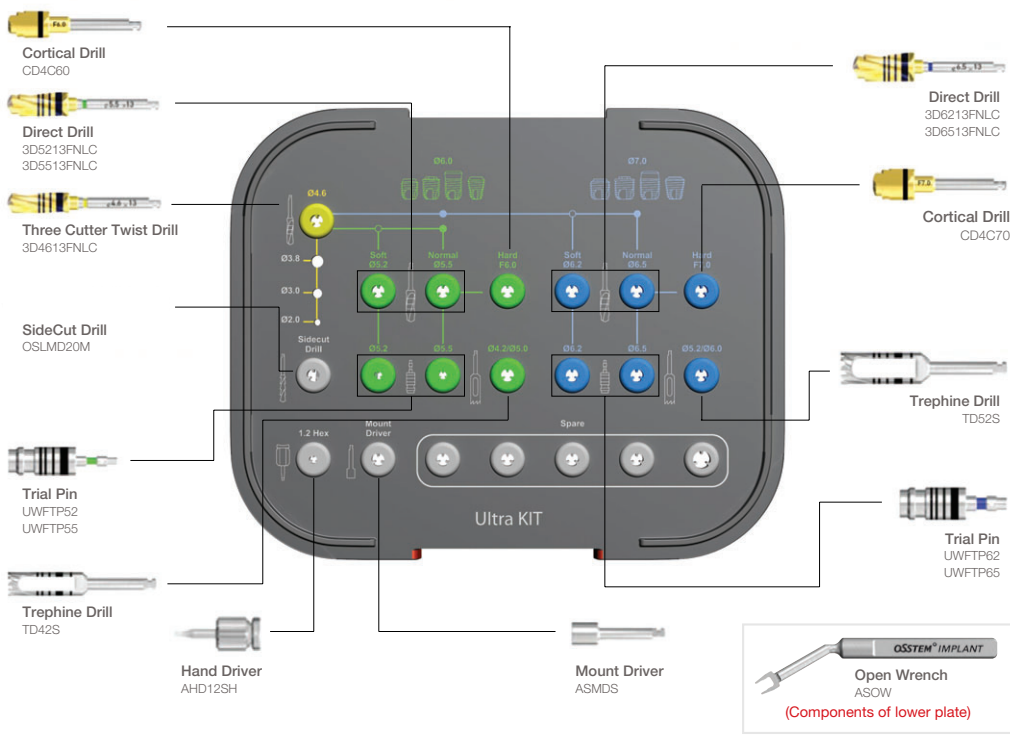

Taper Ultra KIT (HULTPK)

